

Master Bedroom
21'0" X 17'10"

Ensuite

Balcony
28'11" X 14'11"

Living Room
20'2" X 19'5"

Dining Area
15'8" X 14'11"

Kitchen
16'5" X 14'11"

Bedroom
13'7" X 13'3"

Bath

Laundry
10'0" X 6'7"

Carport
23'3" X 11'3"

Garage
23'0" X 22'11"

Entry
15'1" X 9'2"

Scale: 0 5 FEET

FLOOR	FINISHED	UNFINISHED	TOTAL	OT
MAIN	2603	0	2603	GARAGE
LOWER	1991	321	2312	CARPORT

REAL FOTO

1704 MAYNEVIEW TERRACE

DOCUMENT PREPARED FOR THE EXCLUSIVE USE OF

DAVID SHOU

250-388-6998
ORDERS@REALFOTO.CA

All information furnished regarding this property is from sources deemed reliable but no warranty or representation is made to the accuracy thereof.



ROYAL LePAGE
Coast Capital Realty
INDEPENDENTLY OWNED AND OPERATED

LOWER FLOOR

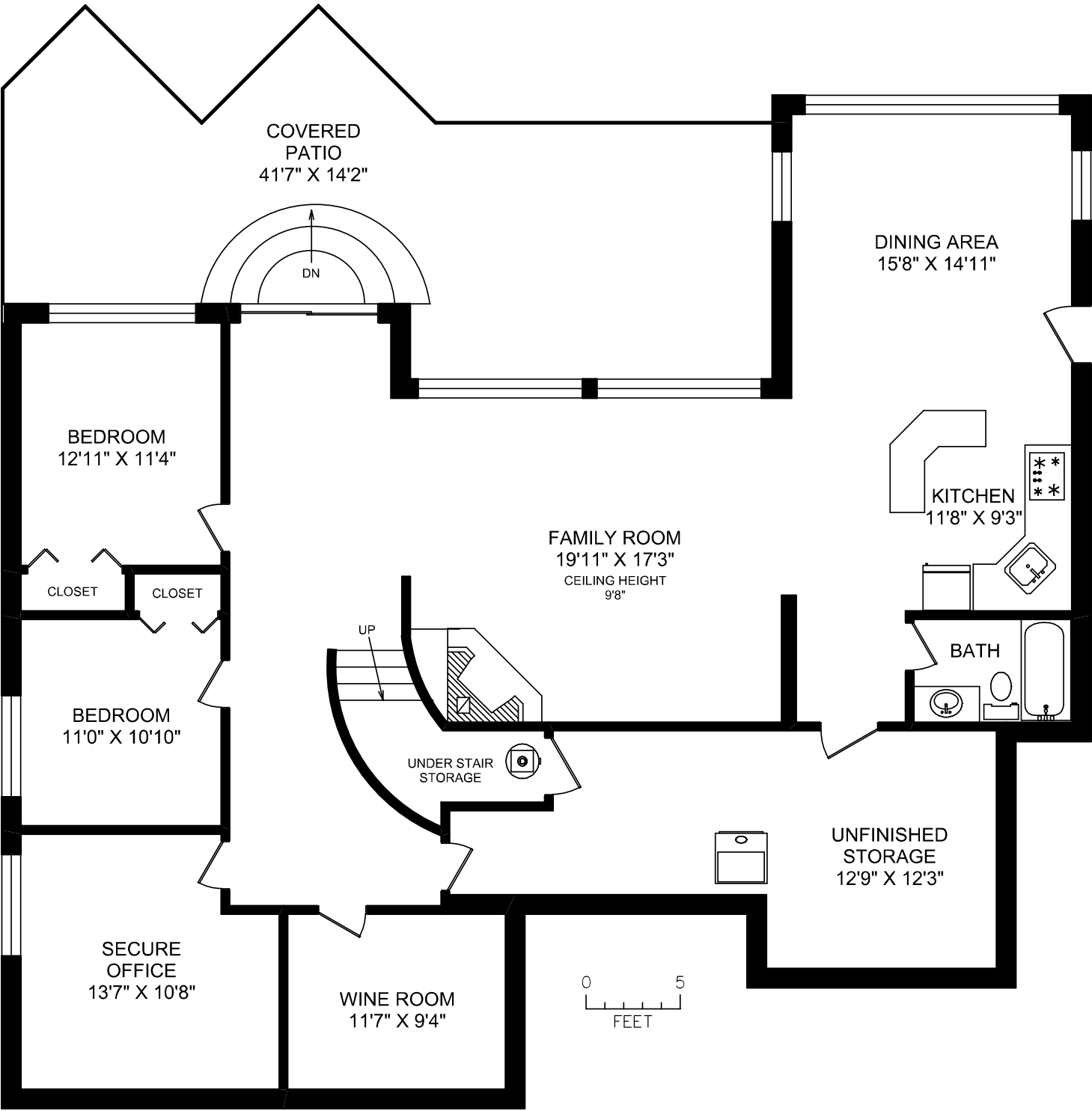

FLOOR	FINISHED	UNFINISHED	TOTAL	OTHER AREAS	
MAIN	2603	0	2603	GARAGE	608
LOWER	1991	321	2312	CARPORT	269
TOTAL	4594	321	4915	PATIO	547
				BALCONY	406



1704 MAYNEVIEW TERRACE

DOCUMENT PREPARED FOR THE EXCLUSIVE USE OF

DAVID SHOU

250-388-6998
ORDERS@REALFOTO.CA MEASURED 02/15/2016 BY DUNCAN GIDNEY
All information furnished regarding this property is from sources deemed reliable but no warranty or representation is made to the accuracy thereof.

